

| UBICACIÓN               | TABLERO | ILUMINACION |         |      | TOMAS |         |       | FUERZA MOTRIZ |         |       | POTENCIA<br>TOTAL<br>VA | CORRIENTE<br>TOTAL<br>A |
|-------------------------|---------|-------------|---------|------|-------|---------|-------|---------------|---------|-------|-------------------------|-------------------------|
|                         |         | BOCAS       | POT. VA | IA   | BOCAS | POT. VA | IA    | BOCAS         | POT. VA | IA    |                         |                         |
| CC1 PB                  | TP2     | 150         | 11250   | 51,1 | 31    | 2325    | 10,6  |               |         |       | 13575                   | 61,7                    |
|                         |         | 25          | 3750    | 6,0  | 14    | 2100    | 9,5   | 1             | 4400    | 7,94  | 10250                   | 46,6                    |
| CC1 PA                  | TP2     | 184         | 13800   | 62,7 | 35    | 10500   | 47,7  |               |         |       | 24300                   | 110,5                   |
|                         |         | 25          | 3750    | 17,0 | 15    | 22500   | 102,3 | 2             | 8800    | 15,88 | 35050                   | 159,3                   |
| EN3 PB                  | TP4     | 66          | 4950    | 22,5 | 14    | 4200    | 19,1  |               |         |       | 9150                    | 41,6                    |
|                         |         | 12          | 1800    | 8,2  | 4     | 6000    | 27,3  |               |         |       | 7800                    | 35,5                    |
| EN3 PA                  | TP4     | 56          | 4200    | 19,1 | 16    | 4800    | 21,8  |               |         |       | 9000                    | 40,9                    |
|                         |         | 12          | 1800    | 8,2  |       |         | 0,0   |               |         |       | 1800                    | 8,2                     |
| EN1                     | TP5     | 20          | 1500    | 6,8  | 12    | 3600    | 16,4  |               |         |       | 5100                    | 23,2                    |
|                         |         | 46          | 4600    | 20,9 | 2     | 1200    | 5,5   |               |         |       | 5800                    | 26,4                    |
|                         |         | 10          | 1500    | 6,8  | 4     | 6000    | 27,3  |               |         |       | 7500                    | 34,1                    |
|                         |         | 32          | 2400    | 10,9 | 12    | 3600    | 16,4  |               |         |       | 6000                    | 27,3                    |
| EX1                     | TP6     | 6           | 900     | 4,1  | 3     | 1800    | 8,2   |               |         |       | 2700                    | 12,3                    |
|                         |         | 28          | 2100    | 9,5  | 6     | 1800    | 8,2   |               |         |       | 3900                    | 17,7                    |
| EX2                     | TP3     | 6           | 900     | 4,1  |       |         | 0,0   |               |         |       | 900                     | 4,1                     |
|                         |         | 60          | 4500    | 20,5 |       |         | 0,0   |               |         |       | 4500                    | 20,5                    |
| ILUMINACION<br>EXTERIOR | TP7     | 7           | 1050    | 4,8  | 15    | 4500    | 20,5  |               |         |       | 5550                    | 25,2                    |
|                         |         | 16          | 2400    | 10,9 |       |         | 0,0   |               |         |       | 2400                    | 10,9                    |
| BOMBA<br>TANQUE         | TP8     |             |         | 0,0  |       |         | 0,0   | 2             | 5000    | 9,03  | 5000                    | 22,7                    |

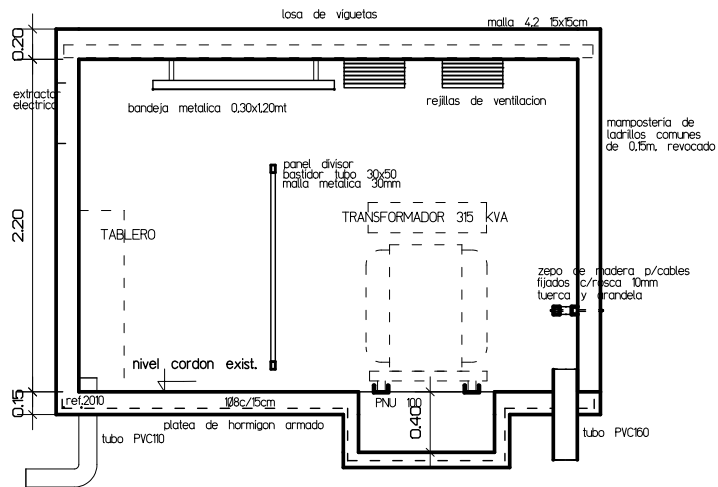

CORTE TRANSVERSAL

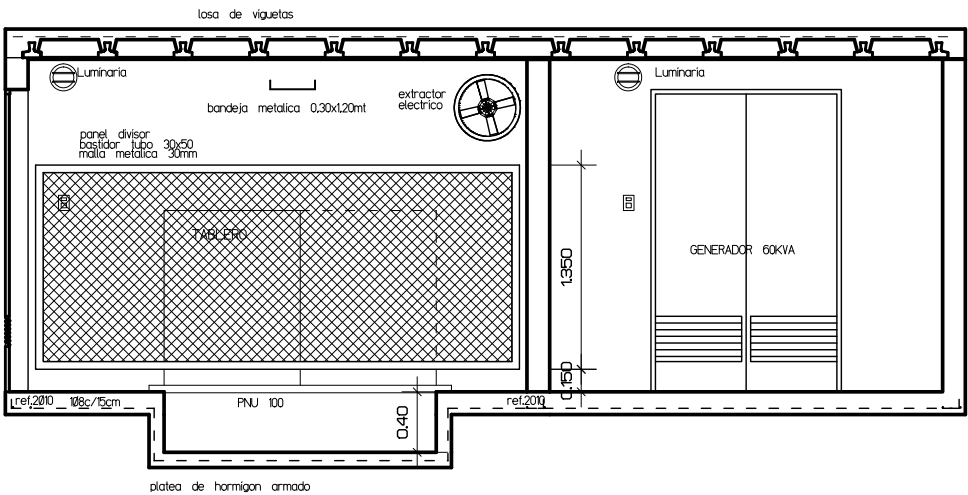

CORTE LONGITUDINAL

PLANTA

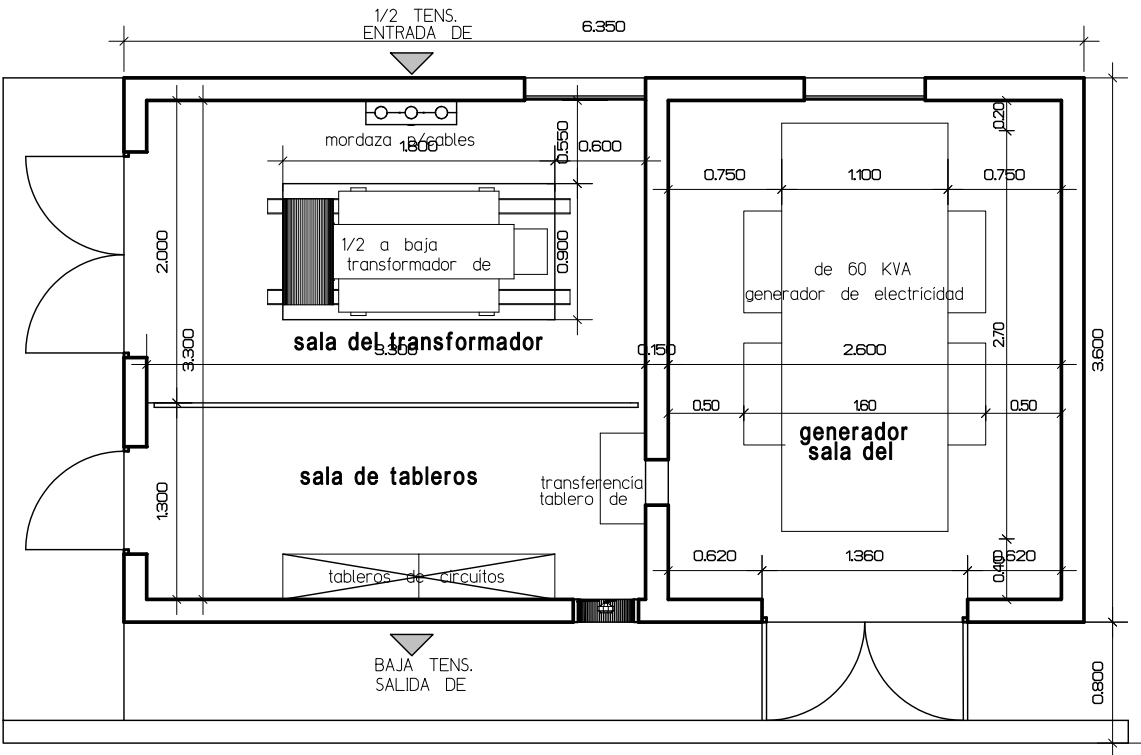

Obra: REFACCION, AMPLIACION Y  
Y PUESTA EN VALOR DEL EDIFICIO  
DEL COLEGIO DEL CENTENARIO

Ubicacion: Av. Rivadavia (O) 701 - Santiago del Estero

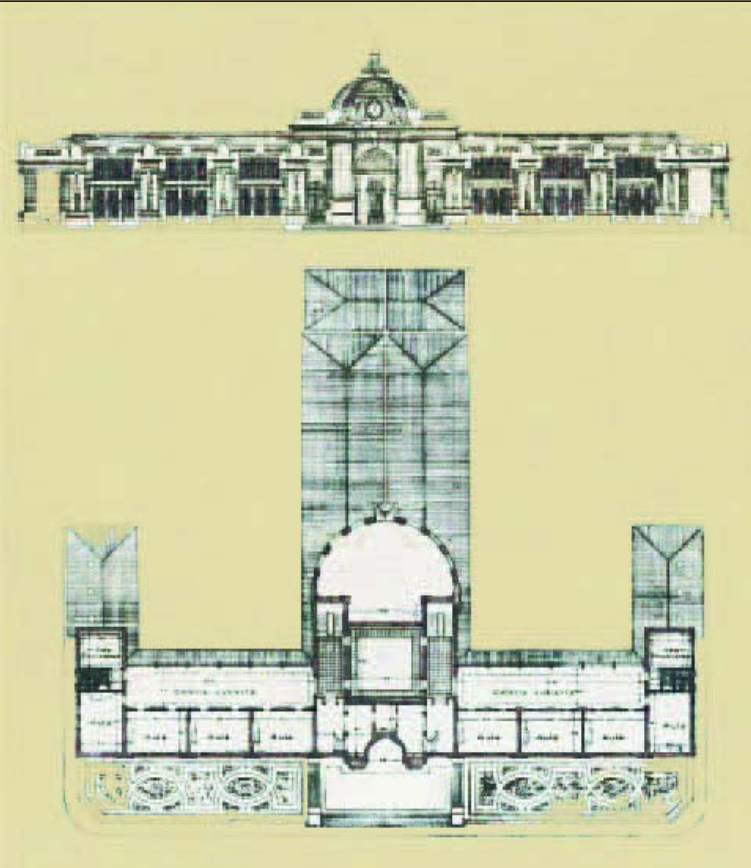

OBSERVACIONES

FECHA Julio del 2016

DESIGNACION  
RECINTO DEL TRANSFORMADOR

PLANO  
PLANTA - CORTES

PLANO Nº 16

ESCALA 1:50

PR1